

STEELITE

DG850 Snow Blower

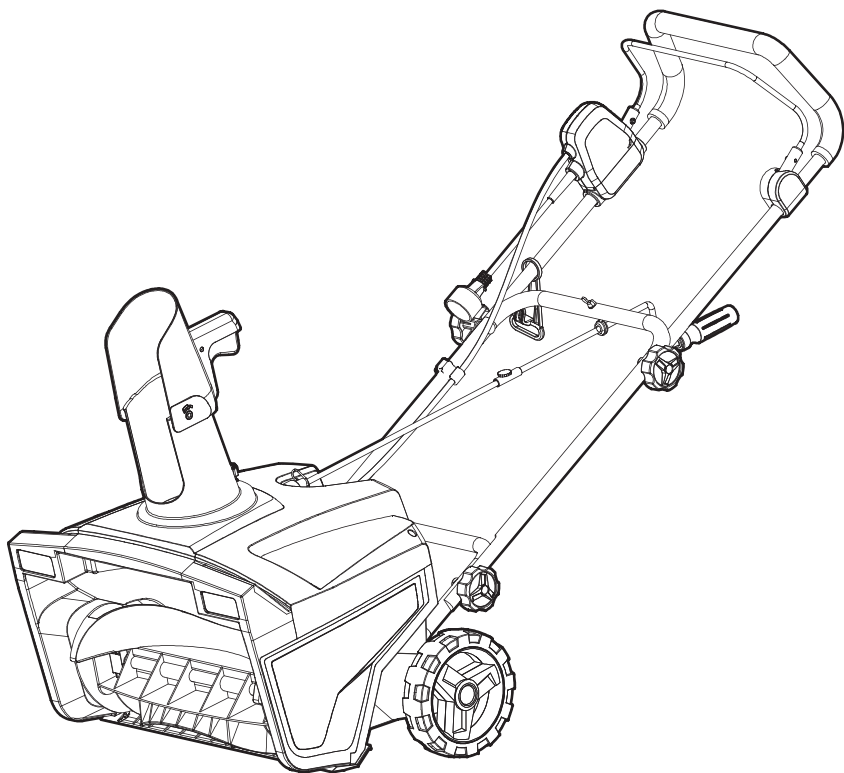

Please read this manual carefully before use
and keep it in a safe place

1 DESCRIPTION

1.1 PURPOSE

This machine is used to remove and clear away snow from pavements, gardens, driveways and other ground-level surfaces.

1.2 OVERVIEW

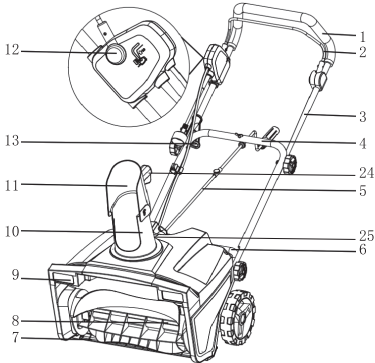

- | | |
|----|------------------------|
| 1 | Handle bar |
| 2 | Bail lever |
| 3 | Upper handle |
| 4 | Middle handle |
| 5 | Chute control rod |
| 6 | Lower handle |
| 7 | Scraper |
| 8 | Impeller |
| 9 | LED light |
| 10 | Discharge chute |
| 11 | Chute deflector |
| 12 | Safety switch button |
| 13 | Cord retainer |
| 24 | Trigger |
| 25 | Discharge chute screws |

2 INTRODUCTION

Your product has been engineered and manufactured to high standards for dependability, ease of operation, and operator safety. When properly cared for, it will give you years of rugged, trouble-free performance.

2.1 INTENDED USE

This product has been designed and built to remove and clear away snow from pavements, gardens, driveways and other ground-level surfaces.

2.2 IMPROPER USE

Any other usage not in keeping with the above mentioned ones may be hazardous and harm persons

and/or damage things. Examples of improper use may include, but are not limited to:

- Use of the product on surfaces above ground level, such as roofs on houses, garages, porticoes or other structures or buildings,
- Activate the auger in the presence of materials other than snow (e.g. soil, grass, pebbles, etc.),
- Pulling or pushing loads,
- Do not carry passengers.

3 GENERAL POWER TOOL SAFETY WARNINGS

WARNING

Read all safety warnings and all instructions. Failure to follow the warnings and instructions may result in electric shock, fire and/or serious injury.

Save all warnings and instructions for future reference. The term "power tool" in the warnings refers to your mains-operated (corded) power tool.

3.1 TRAINING

- Do not allow children under the age of 14 to operate this tool. Children who are 14 years of age or older must read and understand the operating instructions and safety rules in this manual and must be trained and supervised by a parent.
- Read the operating and service instruction manual carefully. Be thoroughly familiar with the controls and the proper use of the appliance. Know how to stop the unit and disengage the controls quickly.
- Never allow children to operate the appliance. Never allow adults to operate the appliance without proper instruction.
- Keep the area of operation clear of all persons, particularly small children, and pets.
- Exercise caution to avoid slipping or falling, especially when operating in reverse.
- Do not use on graveled surfaces.
- Dress Properly – Do not wear loose clothing or jewelry. They can be caught in moving parts.
- Wear rubber boots when operating the appliance.
- Operation of the appliance in the hand-held position is unsafe, except in accordance with the special instructions for such use provided in the operator's manual.

3.2 PREPARATION

- Thoroughly inspect the area where the appliance is to be used and remove all doormats, sleds, boards, wires, and other foreign objects.

- Do not operate the appliance without wearing adequate winter garments. Wear footwear, which will improve footing on slippery surfaces.
- Adjust the housing height to clear gravel or crushed rock surface.
- Never attempt to make any adjustments while the appliance is running (except where specifically recommended by manufacturer).
- Always wear safety glasses or eye shields during operation or while performing an adjustment or repair to protect eyes from foreign objects that may be thrown from the appliance.
- Prevent unintentional starting. Carrying the appliance with your finger on the switch or energizing appliance that have the switch on invites accidents.
- Never direct discharge at bystanders or allow anyone in front of the power tool.
- Disengage power to the collector/impeller when the power tool is transported or not in use.
- Use only attachments and accessories approved by the manufacturer of the power tool.
- Never operate the power tool without good visibility or light. Always be sure of your footing, and keep a firm hold on the handles.
- Walk, never run.
- Use the power tool only in daylight or good artificial light.
- Take all possible precautions when leaving the power tool unattended. Disengage the power take-off, lower the attachments, shift into neutral, set the parking brake, stop the engine and remove the key.

3.3 OPERATION









- Do not put hands or feet near or under rotating parts. Keep clear of the discharge opening at all times.
- Exercise extreme caution when operating on or crossing gravel drives, walks, or roads. Stay alert for hidden hazards or traffic.
- After striking a foreign object, stop the engine, remove the wire from the spark-plug, thoroughly inspect the power tool for any damage, and repair the damage before restarting and operating the power tool.
- If the power tool should start to vibrate abnormally, stop the engine and check immediately for the cause. Vibration is generally a warning of trouble.
- Stop the engine whenever you leave the operating position, before unclogging the collector/impeller housing or discharge guide, and when making any repairs, adjustments, or inspections.
- When cleaning, repairing, or inspecting, make certain the collector/impeller and all moving parts have stopped.
- Disconnect the spark-plug wire, and keep the wire away from the plug to prevent accidental starting. Disconnect the cable on electric motors.
- Do not clear snow across the face of slopes. Exercise extreme caution when changing direction on slopes. Do not attempt to clear steep slopes.
- Never operate the power tool without proper guards, plates or other safety protective devices in place.
- Never operate the power tool near glass enclosures, automobiles, window wells, drop-offs, etc., without proper adjustment of the snow discharge angle. Keep children and pets away.
- Do not overload the power tool capacity by attempting to clear snow at too fast a rate.
- Never operate the power tool at high transport speeds on slippery surfaces. Use care when reversing.

3.4 MAINTENANCE

- Check shear bolts; engine-mounted bolt, etc., at frequent intervals for proper tightness to be sure the appliance is in safe working condition.
- Always refer to owner's guide instructions for important details if the appliance is to be stored for an extended period.
- Store Idle appliances Indoors – When not in use, the appliances should be stored indoors in a dry, locked-up place – out of reach of children.
- Check shear bolts and other bolts at frequent intervals for proper tightness to be sure the equipment is in safe working condition.
- Run the appliance a few minutes after throwing snow to prevent freeze-up of the collector/impeller.
- Do not expose appliance to fire or excessive temperature space. Exposure to fire or temperature above 265°F (130°C) may cause explosion.
- Have servicing performed by a qualified repair person using only identical replacement parts. This will ensure that the safety of the product is maintained.
- Do not modify or attempt to repair the appliance except as indicated in the instructions for use and care.
- Maintain appliance with care - follow instructions for changing accessories.
- Maintain or replace safety and instructions labels, as necessary.





4 SYMBOLS ON THE PRODUCT

Some of the following symbols may be used on this tool. Please study them and learn their meaning. Proper interpretation of these symbols will allow you to operate the tool better and safer.

Symbol	Explanation
	Alternating current
	Precautions that involve your safety.
	Read all the operating instructions carefully. Make sure in advance that you are fully familiar with the operation of the machine.
	Do not use the rotary snowplough when other people, especially children are nearby.
	Cutting or entanglement of foot ---Rotating auger.
	Severing of fingers or hand--- Impeller blade
	Danger ! Turn off motor before unlogging discharge chute
	Wear eye and ear protection.
	Caution ! Unplug immediately if the power cord or plug becomes damaged !

5 RISK LEVELS

The signal words and meanings show the levels of risk related with this machine.

Symbol	Signal word	Explanation
	DANGER:	shows an imminently dangerous situation, which, if you do not prevent, can cause death or dangerous injury.
	WARNING:	shows a possibly dangerous situation, which, if you do not prevent, can cause death or dangerous injury.
	CAUTION:	shows a possibly dangerous situation, which, if you do not prevent, can cause mitigated or moderate injury.
	SAFETY ALERT SYMBOL:	Indicates caution or warning may be used in conjunction with other symbols or pictures.

6 RECYCLE

	WEEE Marking CAUTION ! Unusable power tools do not belong with domestic waste. They must be taken to a communal collecting point for environmentally friendly disposal in accordance with local regulations.
---	---

DOUBLE INSULATED

	Your snow thrower is double insulated. This means that all external parts are electrically isolated from the power supply. This is achieved by placing an extra insulation barrier between the electrical and mechanical parts.
---	---

7 INSTALLATION

WARNING

Do not change or make accessories that are not recommended by the manufacturer.

WARNING

Do not connect to power supply until you assemble all the parts.

7.1 UNPACK THE MACHINE

WARNING

Make sure that you correctly assemble the machine before use.

WARNING

- If the parts are damaged, do not use the machine.
- If you do not have all the parts, do not operate the machine.
- If the parts are damaged or missing, speak to the service center.

1. Open the package.
2. Read the documentation in the box.
3. Remove all the unassembled parts from the box.
4. Remove the machine from the box.
5. Discard the box and package in compliance with local regulations.

7.2 INSTALL THE MIDDLE HANDLE

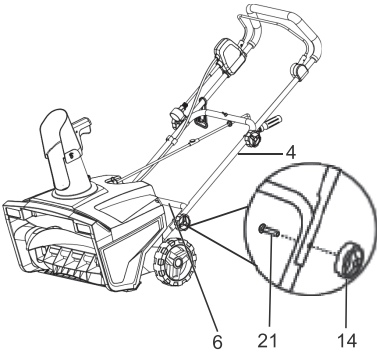

1. Align the holes in the middle handle (4) and the lower handle (6).
2. Put the bolts (21) through the middle handle (4) and the lower handle (6).
3. Tighten the handle knob (14) onto the bolt (21).
4. Repeat for left/right side.

7.3 INSTALL THE UPPER HANDLE

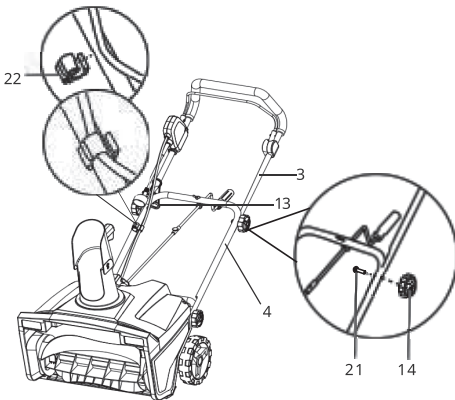

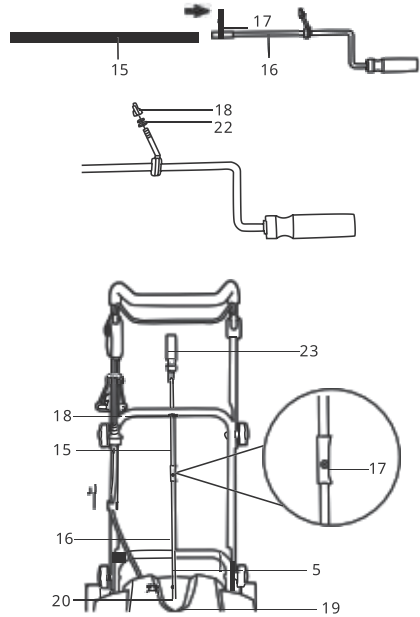

1. Put the cord retainer between the upper handle (3) and middle handle (4).
2. Align the holes in the middle handle (4) and the upper handle (3).
3. Put the bolts (21) through the holes.
4. Tighten the handle knobs (14) onto the bolts (21).
5. Do the same operation on the other side.
6. Attach the cable clamp (22) to the middle handle (4).

7.4 INSTALL THE CHUTE CONTROL ROD



1. Connect the upper lever (15) and lower lever (16) with 1 screw supplied (17).
2. Unscrew the nut (18) and washers (22).
3. Put the bolt of the upper lever (15) through the hole in the middle handle (4). And install the washers (22) and nut (18).
4. Pull out of the hitch pin (20). And then put the end of the chute control rod (5) straight through the hole (19) in the bracket. And Keep the grip handle (23) down.
5. Put the hitch pin (20) through the chute control rod (5) and hole (19).
6. Turn the grip handle (23) left and right to make sure that the discharge chute (10) moves in the same direction.

7.5 INSTALL THE DISCHARGE CHUTE

Align the pilot hole "  " on the discharge chute with the sign "  " on the chute housing. Rotate the discharge chute in the direction indicated by the arrow until it is aligned with the sign "  ". Push the discharge chute into position and tighten the discharge chute screws(25) to lock the discharge chute.

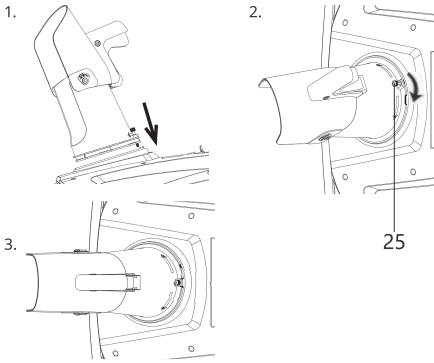

8 OPERATION

⚠ WARNING

Wear eye protection during operation.

8.1 USE THE CORD RETAINER



⚠ NOTE

Do not plug the extension cable into the outlet until it has been connected to the cord retainer and plugged into the machine.

1. Fold the extension cable to form a tight loop near the retainer.
2. Push the loop through the bottom hole in the retainer.
3. Move the loop over the retaining clip, and pull until the cable is secured.

8.2 START THE MACHINE

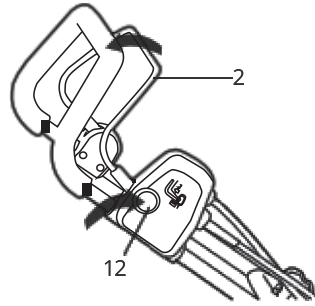

1. While holding the safety switch button (12), pull the bail lever (2) to start the machine.
2. Once the machine powers on, release the safety switch button (12) and begin operation.
3. The machine can only be started by pressing the safety switch button (12) first, followed by squeezing the bail lever (2), reverse operation will not start the machine.

⚠ NOTE

Lower the scraper to the ground to remove the snow.

⚠ WARNING

Keep bystanders a safe distance from the machine.

⚠ WARNING

Examine the work area. Remove all stones, sticks, wire, bones, and other debris that can ricochet because of the rotating impeller.

8.3 STOP THE MACHINE

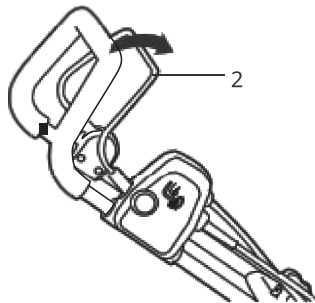

1. Release the bail lever (2) to stop the machine.

⚠ WARNING

Wait until the impeller fully stops before you start the machine again. Do not quickly turn the machine off and on.

8.4 ADJUST THE DISCHARGE CHUTE

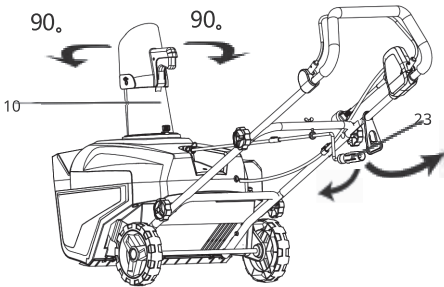

You can adjust the discharge chute 180° to change the snow direction.

1. Turn the grip handle (23) left to move the discharge chute (10) to the left.
2. Turn the grip handle (23) right to move the discharge chute (10) to the right.

8.5 ADJUST THE CHUTE DEFLECTOR

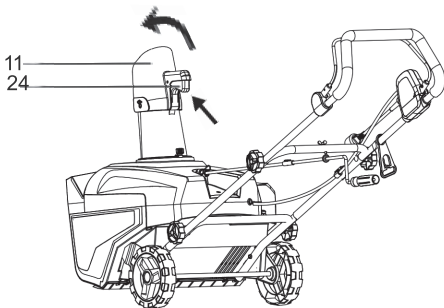

You can adjust the chute deflector up and down to change the throwing distance of the snow.

⚠ WARNING

Release the bail lever before you adjust the chute deflector.

⚠ WARNING

Do not push the deflector so far forward that a gap shows between the deflector and the chute.

1. The chute deflector (11) on the top of the discharge chute controls the height of the snow stream. Squeeze the trigger (24) to raise or lower the deflector to the desired height of snow you wish to throw.

8.6 OPERATION TIPS

- If it is possible, clear the snow with the direction of the wind.
- In strong winds, lower the chute deflector to direct the snow to the ground.
- When you complete the work, let the machine operate for a while to prevent ice formation in the discharge chute.
- If the snow is deeper than 8", decrease the speed and let the machine work at its own rhythm.
- Do not use the scraper to remove compact snow and ice.

⚠ WARNING

Pull the plug after you complete the work.

9 MAINTENANCE

⚠ WARNING

Disconnect the extension cord before maintenance.

⚠ CAUTION

Use only approved replacement parts.

⚠ CAUTION

Do not use strong solvents or detergents on the plastic housing or components.

9.1 GENERAL MAINTENANCE

- Before each use, examine the machine for damaged, missing, or loose parts such as screws, nuts, bolts and caps.
- Tighten correctly all the fasteners and caps.
- Clean the remaining snow on the machine with a brush.

9.2 REPLACE THE SCRAPER



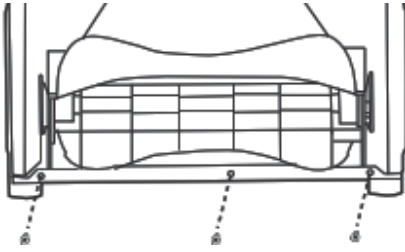

⚠ WARNING

Use only approved replacement scrapers.

⚠ WARNING

Wear heavy gloves or wind cloth around the impeller when you touch the impeller.

1.2. Remove the 6 screws (21) .

Remove and discard the old scraper.

3. Install the new scraper.

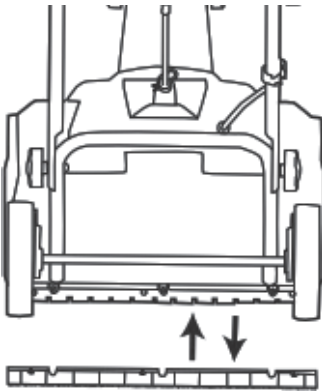

4. Put in the screw (21) and scraper and tighten them.

9.3 REPLACE THE IMPELLER

⚠ WARNING

Use only approved replacement scrapers.

1. Remove the 10 screws and side wear pads that secure the right and left side covers.

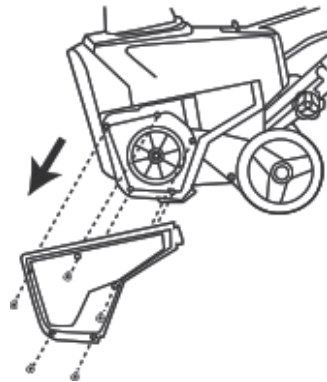
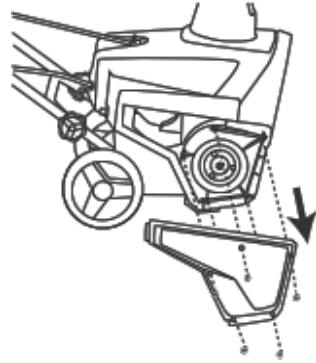

2. Remove the belt, unscrew the nut and then remove the washer, large pulley and washer.

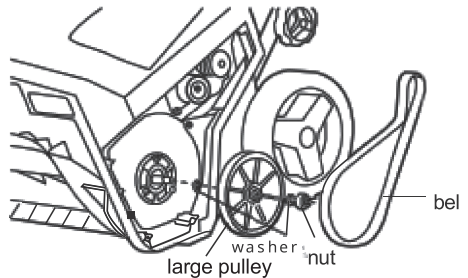

3. Unscrew the nut with flat washer and spring washer, remove the splint. Do the same operation on the other side.

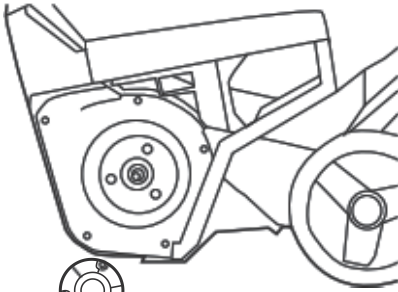

- Remove the bearing, impeller axle, washer and old impeller. And then remove the insert blocks from the old impeller to the new impeller.

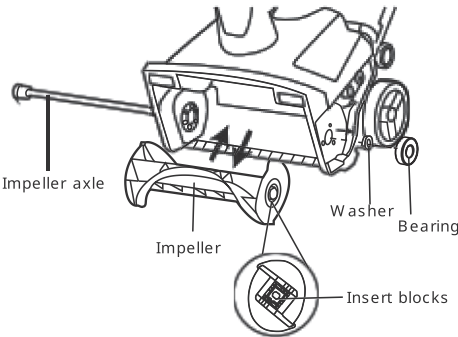

- Reinstall the new impeller, impeller axle, washer and bearing in order.
- Reinstall the splint, nut with flat washer and spring washer.
- Reinstall the washer, large pulley and washer. And screw the nut, reinstall the belt.
- Reinstall the 10 screws and side wear pads that secure right and left side covers.

9.4 STORE THE MACHINE

- Clean the machine before storage.
- Make sure the motor is not hot when you store the machine.
- Make sure that the machine does not have loose or damaged parts. If it is necessary, do these steps/instructions:
 - Replace the damaged parts.
 - Tighten the bolts.

- Speak to a person at an approved service center.
- Store the machine in a dry area.
- Make sure that children cannot come near the machine.

10 TROUBLESHOOTING

Problem	Possible cause	Solution
The handle is not in position.	The bolts are not engaged correctly.	Adjust the height of the handle and make sure that the knobs and bolts are aligned correctly.
The machine does not start.	The switch is defective.	Have the switch replaced by an authorized service center.
	The extension cord is not connected to the plug.	Connect the plug on the machine to the extension cord.
	The extension cord is not connected to the power source.	Plug the extension cord into a live 120 V AC, 60 Hz outlet.
The engine is on, but the impeller does not turn.	The belt is damaged.	Replace the belt.
A thin layer of snow stays behind.	The scraper is damaged.	Replace the scraper.

* If you cannot find the solution to these problems, please go to the service center.

11 TECHNICAL DATA

Voltage	120 V, 15A
No load speed	3000/min
C clearing width	20 inch
C clearing depth	10 inch
Impeller size	6.8 inch
Weight (without battery pack)	13.3 kg
Double-insulated construction	

STEELITE

Product Warranty Card

Dear users :

Thank you for buying our products. In order to ensure your profit, users who buy our products can contact local distributor or Specified repair stations with invoice and warranty cards if the product failures due to quality problems.

Warranty Notice:

1. We will provide a 2-year limited warranty for the machine , starting from the date of your purchase.
2. This warranty card and purchase invoice are the voucher of after-sales service provided by our company to customers. The card must be detailed only after filling in the following form and affixing the official seal with the distributor.
3. In one of the following cases, free warranty service will be invalid, and maintenance fees will be required:
 - (1) Exceed the expiration date.
 - (2) Failure or damage caused by not following the requirements of the product manual, maintenance or improper storage.
 - (3) Failure or damage caused by disassembling, repairing or modication of the product without the permission of our company.
 - (4) Machine breakdown or damage caused by force majeure.
 - (5) Consumable accessories.

This card is issued with the product. One card for one machine, to ensure that you can fully enjoy the right to free warranty service provided by the company, please keep this card properly, lost will not be replaced.

Purchase Date: _____ (Year/Month/Day)

Product Certificate

Inspector:

01

Date of manufacture:

NINGBO DELI TOOLS CO., LTD.
No. 128 Chezhan West Road, Huangtan Town,
Ninghai County, Ningbo, Zhejiang, China
delitoolsglobal@nbdeli.com
CUSTOMER SUPPORT EMAIL: service@steelitetool.com
+1 888-909-8850
MADE IN CHINA

