

ZENTOR

ZT820-1

CORDLESS JOBSITE BLOWER

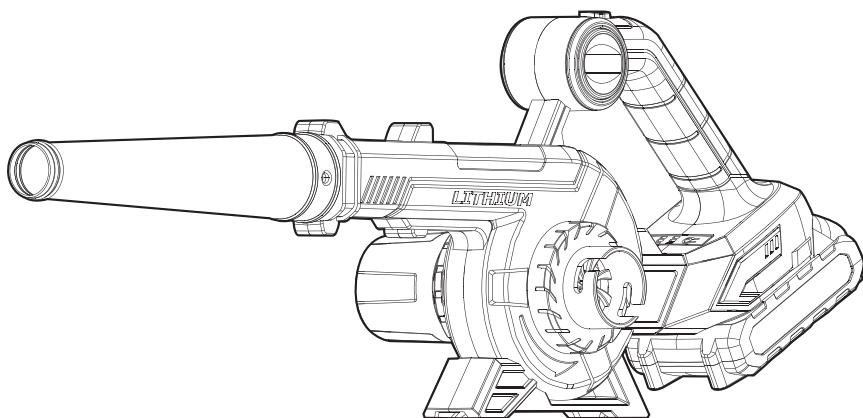







Please read this manual carefully before use
and keep it in a safe place

Specifications

Model	ZT820-1
Voltage	20V 
Rated speed	13000rpm
Rated air pressure	3.0kpa
Rated air speed	22m/s

Symbols

 Read the instructions	 Warning signs	 Do not throw it into the fire	 Do not throw it into the water
 Please wear protective earmuffs	 Please wear protective goggles	 Please wear protective mask	

General warning for the DC power tools

General safety warning for the hand-held power tools

Warning!

Read all warnings and instructions. Failure to follow the below warnings and instructions can result in electric shock, fire and/or serious injury.

Save all warnings and instructions for reference.

The term "power tool" refers to mains-operated (corded) power tools in all the following warnings.

General safety warning for power tools - work area

- Keep work area clean and well lit.**
Cluttered or dark areas invite accidents.
- Do not operate power tools in explosive atmospheres, such as in the presence of flammable liquids, gases or dust.** Power tools create sparks which may ignite the dust or gases.
- Keep children and bystanders away before operating the power tools.**
Distractions can cause the operator to lose control of tools.

General safety warning for the power tools - electrical safety

1. **The plug of power tools must match the socket.** Never modify the plugs in any way. Power tools that require grounding cannot use any conversion plugs. The unmodified plugs and their matching sockets will help reduce the risk of electric shock.
2. **Avoid human contact with the grounded surfaces, such as pipes, heat sinks and refrigerators.** It will increase the risk of electric shock if your body comes into contact with the grounded surfaces.
3. **Do not expose power tools to rain or damp environments.** It will increase the risk of electric shock when water enters the power tools.
4. **Do not abuse the wires. Never transport and pull the power tools or remove the plugs with wires. Keep the power tools away from heat sources, oil, sharp edges, or movable parts.** Damaged or twisted power cords can increase the risk of electric shock.
5. **When the power tool is used outdoors, use the external cords suitable for outdoor use.** A cord suitable for outdoor use will reduce the risk of electric shock.
6. **If it is unavoidable to operate the power tool in a damp location, a residual current operated protective device (RCD) should be used.** It can reduce the risk of electric shock if RCD is used.
4. **Remove any adjusting keys or wrench before turning the power tool on.** A wrench or a key that is left attached to a rotating part of the power tool may result in personal injury.
5. **Don't stretch your hands too long, and keep proper footing and body balance at all times.** In this way, the power tool can be well controlled in unexpected situations.
6. **Dress properly. Do not wear loose clothing or jewelry.** Keep your clothing, gloves and hair away from moving parts. Loose clothes, jewelry or long hair can get caught in moving parts.
7. **If devices are provided for the connection of dust extraction and collection facilities, ensure these are well connected and properly used.** Use of these facilities can reduce dust-related hazards.

General safety warning for power tools - use and precautions of power tools

1. **Do not abuse the power tools. Use the correct power tools for your application.** The correct power tool will do the job better and safer.
 2. **Do not use the power tool if the switch does not turn it on and off.** Any power tool that cannot be controlled with the switch is dangerous and must be repaired.
 3. **Before making any adjustments, changing accessories or storing power tools, the plug must be unplugged from the power supply and/or the battery case must be disconnected from the tool.** Such preventive safety measures can reduce the risk of starting tool accidentally.
 4. **Store idle power tools out of the reach of children and do not allow persons unfamiliar with the power tool or these instructions to operate the power tool.** Power tools are dangerous for untrained users.
 5. **Maintain power tools. Check whether the moving parts are properly adjusted or stuck, check the damage of the parts and other conditions that affect the operation of power tool.** If damaged, the power tool should be repaired before use. Many accidents are caused by poorly maintained
1. **Stay alert, watch what you are doing and use common sense when operating the power tool. Do not use a power tool while you are tired or under the influence of drugs, alcohol or medication.** A moment of inattention while operating power tools may result in serious personal injury.
 2. **Use personal protective equipment. Always wear protective goggles,** and safety equipment such as dust mask, non-skid safety shoes, safety helmets or hearing protection which are used for appropriate conditions will reduce personal injuries.
 3. **Avoid accidental starts. Ensure that the switch is in the off-position when**

power tools.

6. **Keep cutting tools sharp and clean.**

Properly maintained cutting tools with sharp cutting edges are less likely to get stuck and are easier to control.

7. **Use power tools, accessories and tool bits, etc., in the manner specified in instruction manual, taking into account the working conditions and the work to be performed.** Use of the power tool for operations different from those intended could result in a hazardous situation.

**General safety warning for power tools
- use and precautions of battery-operated tools**

1. **Use only the charger specified by the manufacturer for charging.** There may be a fire hazard when using a charger suitable for a certain battery pack with another battery pack.
2. **Only use power tools equipped with dedicated battery packs.** Using other battery packs may cause injury and fire hazard.
3. **When the battery pack is not in use, keep it away from other metal objects such as paper clips, coins, keys, nails, screws or other small metal objects, in order to prevent one end of the battery pack from connecting to the other end.**
A short circuit at the end of the battery pack may cause combustion or fire.
4. **If the battery is abused, liquid may splash out of the battery pack; avoid contact with it. If you accidentally come into contact with the liquid, wash the affected area with water. If the liquid gets into eyes, please seek medical assistance.** The liquid splashed out of the battery may cause corrosion or fire.
5. **Do not use damaged or modified battery packs or tools.** Damaged or modified battery packs may produce unpredictable results, leading to fire, explosion or injury.
6. **Do not expose the battery pack to fire or high temperatures.** If the battery pack is exposed to fire or high temperatures above 130 °C, it may cause an explosion.

General safety warning for power tools - repair of battery-operated tools

1. **Ask the professional maintenance staff to repair the power tools with the same spare parts.** This will ensure the safety of the power tools to be repaired.
2. **Never repair a damaged battery pack.**
The battery pack can only be repaired by the manufacturer or its authorized repair service provider.

General safety warning for power tools - air blower

1. **Do not point the air blower at people when using it.** This may cause harm to the human body.

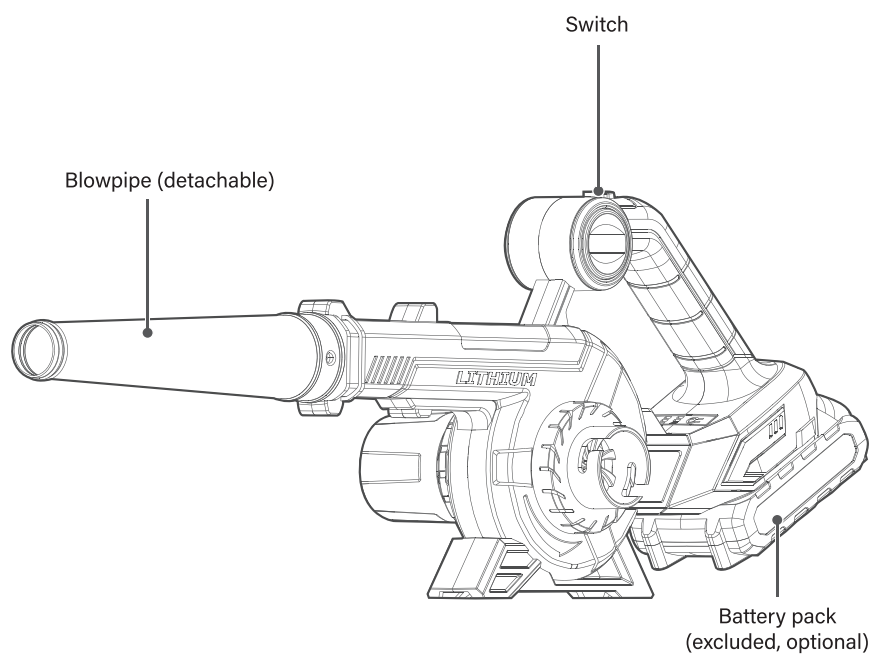

Troubleshooting

1. Why doesn't the blower work after turning on the switch?

It may be that the battery pack is not inserted properly or the battery pack is out of power. Please reinsert the battery pack until you hear a click sound, or charge the battery pack.

Maintenance

 **Warning! Before performing any replacement or maintenance work on the machine, be sure to pull out the plug first.**

Before performing any replacement or maintenance work on the machine, be sure to pull out the battery first.

Your power tool does not require any additional lubrication or maintenance. Do not clean your power tools by using water or chemical cleaning agents, just wipe them clean with a dry cloth. Tools should be stored in a dry environment and kept clean at the motor vents. Try not to use it in a dusty environment.

Environmental protection



Disposal of waste

In response to environmental protection, damaged machines, accessories and packaging materials must be sorted carefully for easy recycling. In order to facilitate sorting and recycling, all plastic parts are marked with materials.



Product Warranty Card

Dear users :

Thank you for buying our products. In order to ensure your profit, users who buy our products can contact local distributor or Specified repair stations with invoice and warranty cards if the product failures due to quality problems.

Warranty Notice:

1. From _____ (Year/Month/Day) to _____ (Year/Month/Day), If the failure happen in normal use, our company will provide free warranty, parts replacement and other services according to the failure situation.
2. This warranty card and purchase invoice are the voucher of after-sales service provided by our company to customers. The card must be detailed only after filling in the following form and affixing the official seal with the distributor.
3. In one of the following cases, free warranty service will be invalid, and maintenance fees will be required:
 - (1) Exceed the expiration date.
 - (2) Failure or damage caused by not following the requirements of the product manual, maintenance or improper storage.
 - (3) Failure or damage caused by disassembling, repairing or modication of the product without the permission of our company.
 - (4) Machine breakdown or damage caused by force majeure.
 - (5) Consumable accessories.

This card is issued with the product. One card for one machine, to ensure that you can fully enjoy the right to free warranty service provided by the company, please keep this card properly, lost will not be replaced.

Purchase Date: _____ (Year/Month/Day)

Product Certificate

Inspector:

01

Date of manufacture:

NINGBO DELI TOOLS CO., LTD.
No. 128 Chezhan West Road, Huangtan Town,
Ninghai County, Ningbo, Zhejiang, China
+86 574 87562689
MADE IN CHINA

